

1500RPM DIESEL GENERATOR QUICK START GUIDE

VOLTARUS[®]

Safety



Electric Shock



Electric Warning



Do not touch hot surface



Warning crush falling object



Keep away from children



No naked flames



No smoking



Mechanical injury



Keep Earthing



Battery Acid



Explosive Gas



Exhaust gas harmful

Installation

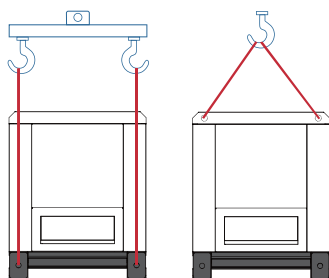

Use the correct lifting method

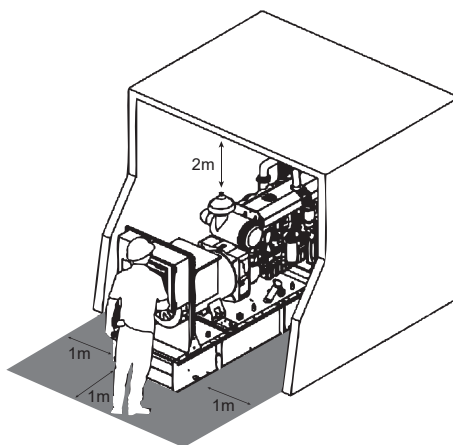
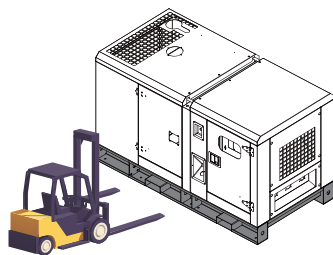

Reserve enough operation and maintenance space

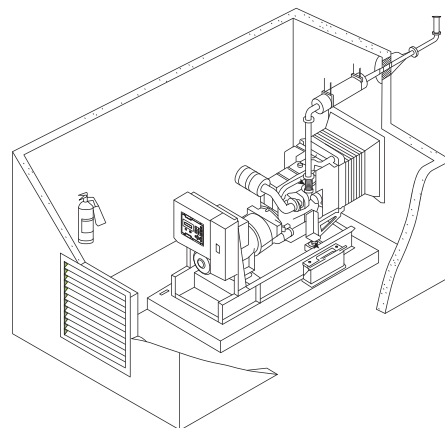

Make good exhaust facilities

Before start

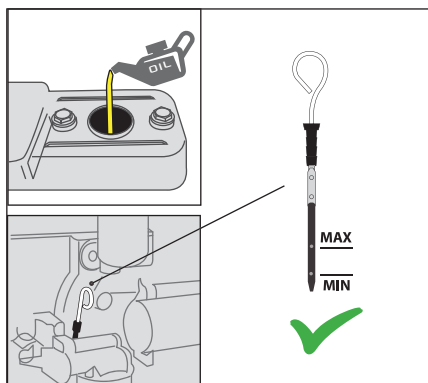

Add oil

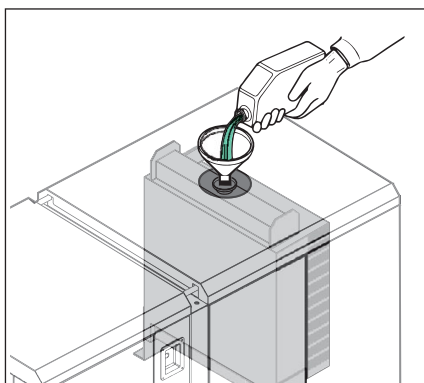

Add Coolant

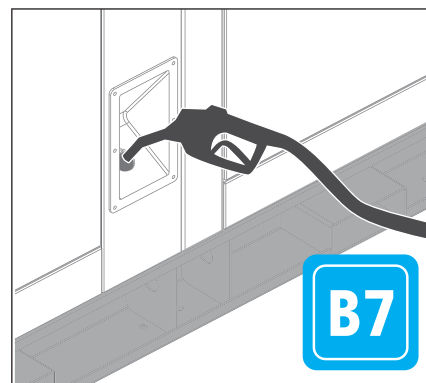

Add Fuel



Start



Close breaker

1

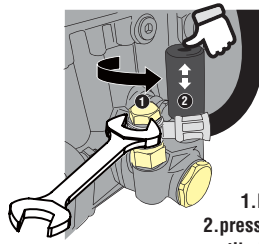

1. loose oil outlet bolt ①
2. press manual fuel pump ② until oil outlet bolt ① comes out oil and no bubble
3. screw the oil outlet bolt ①

2

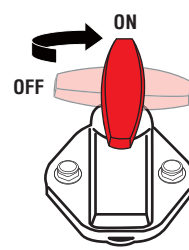

Turn on the battery switch

3



Check the fuse (CPS)
pull up the air breaker

4

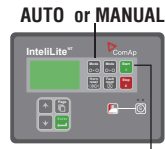

Start button



Power key switch



Only Emergency STOP

5

Turn on power key switch
and press start button to start the generator

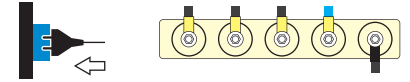

Single phase load, connect socket (<16A)
Three phase load, please connect the binding post

6

In-service inspection



Coolant Temp < 95°C



Pressure > 1.5 bar



Fuel > 1/4



Check leakage
(fuel, oil, coolant)



Any emergency,
press emergency button

Stop

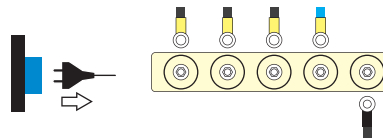

Single phase load, disconnect socket (<16A)
Three phase load, disconnect the binding post



Close breaker



STOP button



Power key switch

Press STOP button
After shutdown turn off power key switch

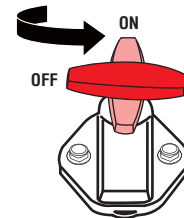

Turn OFF the battery switch

Maintenance

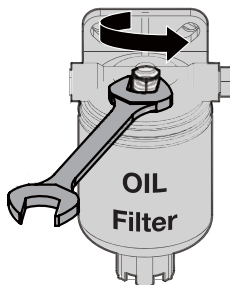

Replace oil & oil filter
each 100h operation

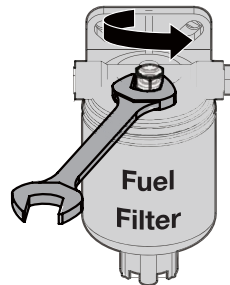

Replace fuel filter
each 100h operation

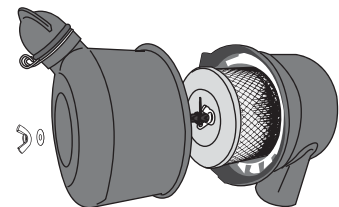

After continuous running of 400h,
replace the air filter.
In bad condition,
Please shorten the replacement time